

# Fastener Tightening Specifications

Application	Specification	
	Metric	English
Front Seat Back Frame Bolt	50 N·m	37 lb ft



# Driver Seat Schematics

## Power Seats

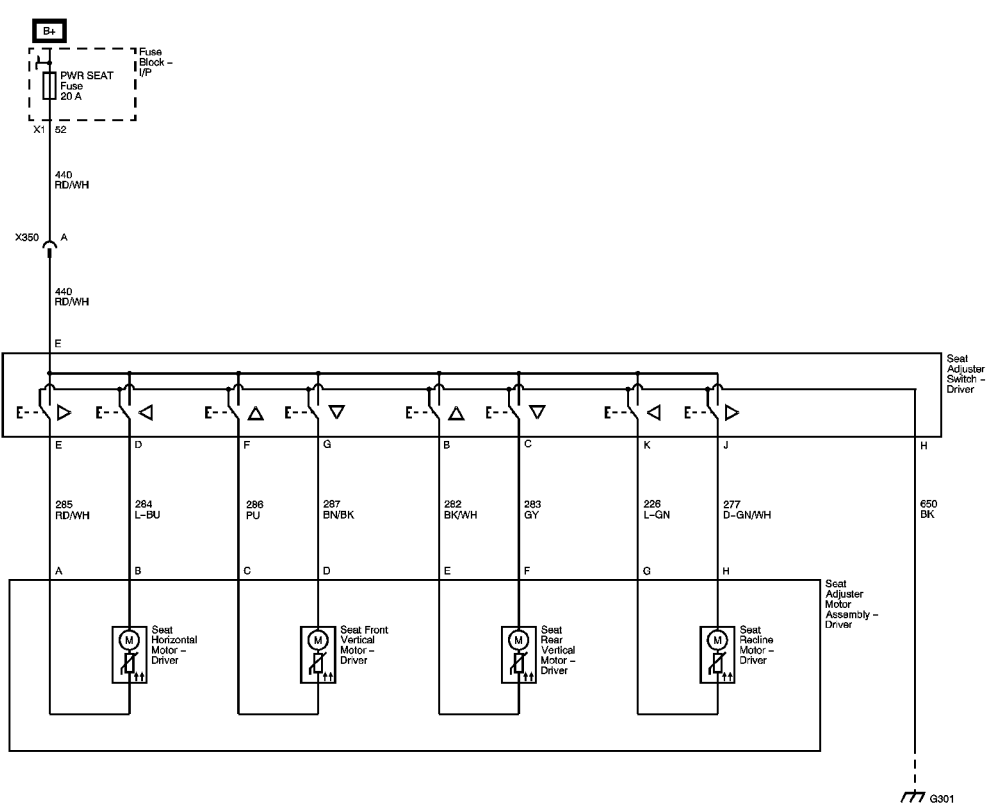

# Driver Seat Cushion Frame Replacement

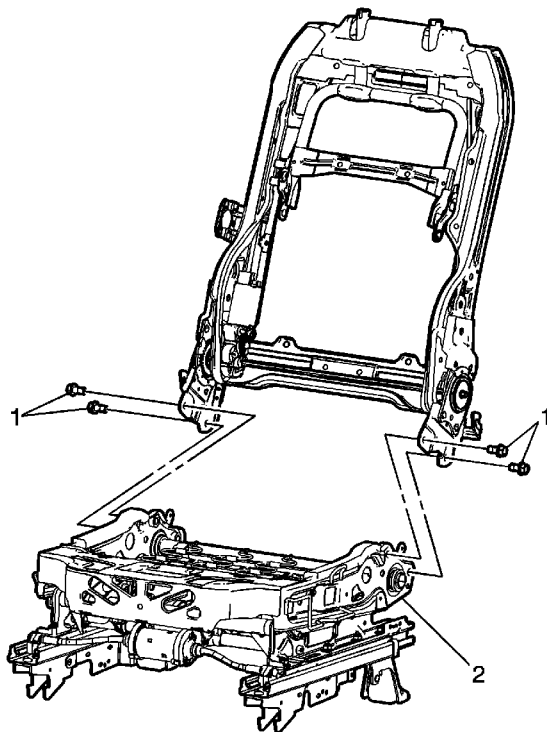

Callout	Component Name
<b>Preliminary Procedures</b>  1. Remove the front seat back cushion cover and pad. Refer to <a href="#">Front Seat Back Cushion Cover and Cushion Pad Replacement</a> . 2. Remove the front seat cushion cover and pad. Refer to <a href="#">Front Seat Cushion Cover and Pad Replacement</a> .	
1	Front Seat Back Frame Bolt (Qty: 4)  <b>Caution:</b> Refer to <a href="#">Fastener Caution</a> in the Preface section.  <b>Tighten</b> 50 N·m (37 lb ft)
2	Driver Seat Cushion Frame  <b>Procedure</b>  1. Disconnect the electrical connector. 2. If replacing the driver seat cushion frame transfer components as necessary.

# Power Seat Switch Replacement

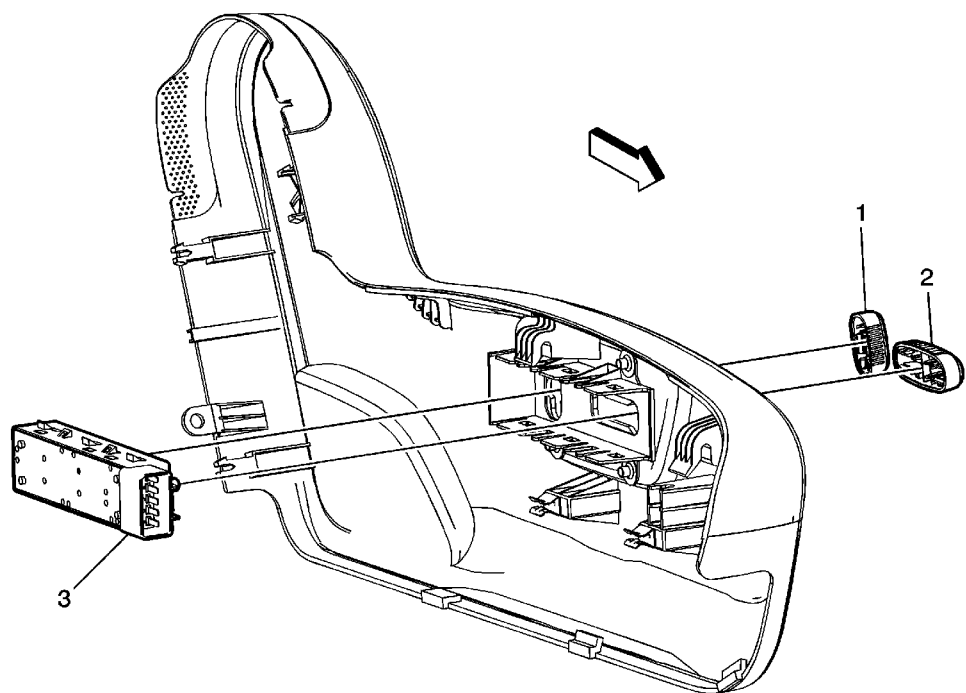

Callout	Component Name
<b>Preliminary Procedures</b>	
Remove the front seat outer adjuster finish cover. Refer to <a href="#">Driver Seat and Passenger Seat Outer Adjuster Finish Cover Replacement</a> .	
1	Front Seat Back Recliner Knob <b>Tip</b> Pull the know outward to remove.
2	Front Seat Adjuster Knob <b>Tip</b> Pull the know outward to remove.
3	Front Seat Adjuster and Recliner Switch <b>Tip</b> Use a small flat bladed tool if necessary to help remove the switch from the adjuster finish cover.

